

Low Profile Aluminum Framing System!

EASY Installation Steps:

1. Attach CLIPS to Porch Frame

Measure & pre-mark clip locations on the frame with a level ruler or string to keep the clips aligned at desired location on the frame for proper channel installation. Place Clips 2" from the corners and every 10" evenly spaced apart with flat sides of clips parallel to the frame, using #6 x 3/4" Stainless Steel Hex Head screws. Do not overtighten. (Do not exceed a maximum of 50 square feet per screened in area.)



2. Attach MINitrack™ CHANNEL to CLIPS

Now MINitrack Channel pieces should be cut to desired lengths. Install the left & right channel vertical's by just "snapping" them over clips directly attached to the frame using a rubber mallet.

Next, install both the top and bottom MINitrack channel horizontal's (See A Diagrams for details)

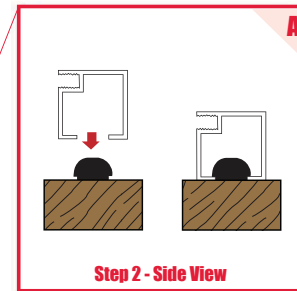

3. Roll SCREEN into MINitrack™ CHANNEL

Now using the spline, Rollerknife™ Screening Tool & screen mesh material, is simply roll the spline into the groove of the MINitrack channel to hold in the fabric. Starting with the top, working your way to the sides and bottom of each section to be screened.

4. Simply trim off the excess screen mesh and you're done!

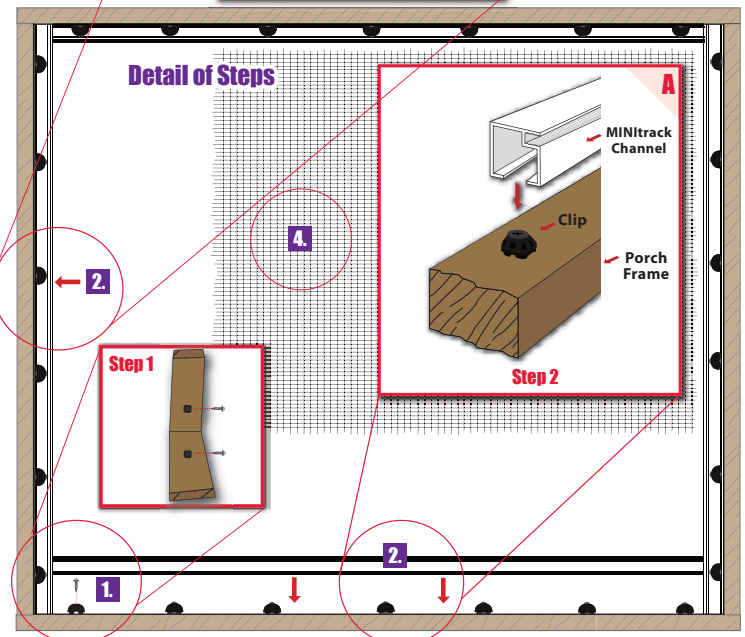

Attach Clips to Frame



Attach Channels to Clips

Attach Horizontals 1st, Verticals 2nd



Tools & Other Materials Needed:

- Chop Saw
- Rollerknife™
- Spline
- Screw Driver/Drill
- Rubber Mallet
- Fasteners
- Fiberglass Screen

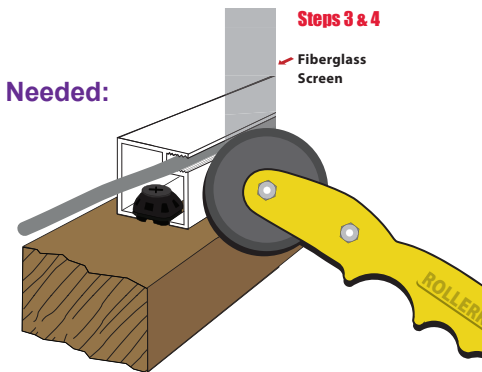

For more information please visit us on our website www.screentight.com. Thank you.

